



Elektrotechnische Fabrik  
GmbH & Co. KG

Bevertalstraße 20  
D-42499 Hückeswagen  
Phone: +49 2192 9166 0  
Fax: +49 2192 9166 66

## Mounting

- Drill a hole with  $\varnothing 11$  mm for the connection cable
- Insert the connection cable through the hole
- Adjust the pole mount socket and press it against the pole
- Fasten the pole mount socket to the pole with the two drilling screws (4,8 x 22; SAF8)

## Connection

- Insert the connecting cable into the cable fuse box and connect according to the cable assignment

## Maintenance

- Open the maintenance flap using the knurled screw
- Switch on protective switch (RCD /RCB; RCBO) again
- Close maintenance flap properly

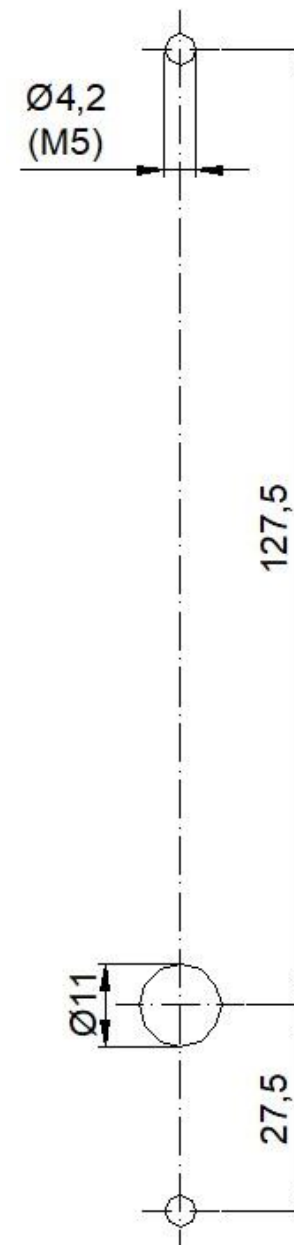
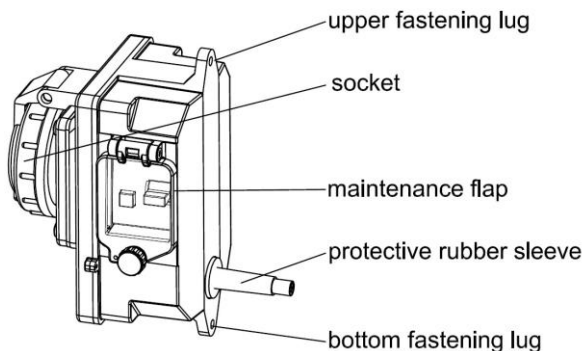

**drill pattern**  
scale 1:1

## Installation Instructions

Pole mount socket HSW 4042

### Intended use

The pole mount socket HSW 4042 is intended to add-on to suitable lighting poles.  
Any other use of this product requires the consultation with the manufacturer.

### Safety instructions

When working on electrical systems, the valid regulations such as VDE 0100 must be observed. Installation may only be carried out by qualified personnel or instructed persons in a de-energized state.

### Service

In the event of malfunctions or complaints regarding the product, please contact your sales representative or the manufacturer.

### Technical data

Socket	Safety socket outlet IP68
Nominal voltage / -current	250 V / 16 A
Degree of protection	IP66
Measurements (L x W x H)	168 x 106 x 107 mm