



Elektrotechnische Fabrik
GmbH & Co. KG

Bevertalstraße 20
D-42499 Hückeswagen
Phone: +49 2192 9166 0
Fax: +49 2192 9166 66

Mounting

- Drill a hole with $\varnothing 11 \text{ mm}$ for the connection cable
- Insert the connection cable through the hole
- Adjust the pole mount socket and press it against the pole
- Fasten the pole mount socket to the pole with the two drilling screws (4,8 x 22; SAF8)

Connection

- Insert the connecting cable into the cable fuse box and connect according to the cable assignment

Maintenance

- Open the maintenance flap using the knurled screw
- Switch on protective switch (RCD /RCB; RCBO) again
- Close maintenance flap properly

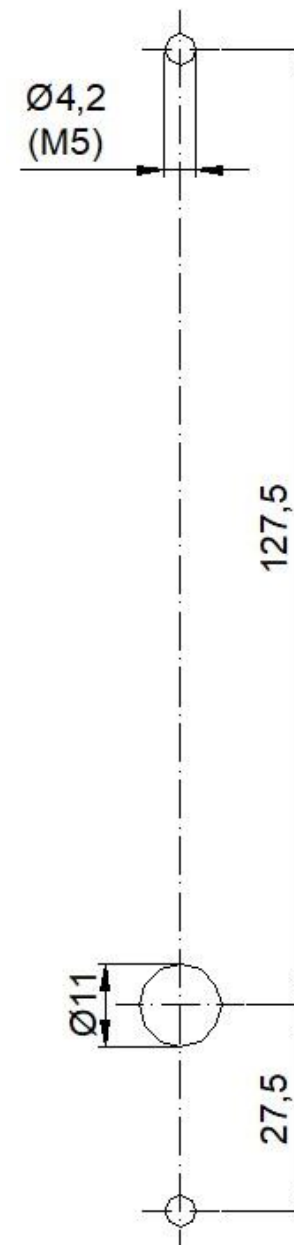
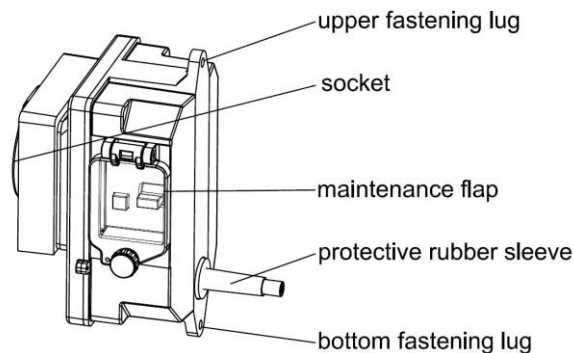

drill pattern
scale 1:1

Installation Instructions

Pole mount socket HSW 4041

Intended use

The pole mount socket HSW 4041 is intended to add-on to suitable lighting poles.
Any other use of this product requires the consultation with the manufacturer.

Safety instructions

When working on electrical systems, the valid regulations such as VDE 0100 must be observed. Installation may only be carried out by qualified personnel or instructed persons in a de-energized state.

Service

In the event of malfunctions or complaints regarding the product, please contact your sales representative or the manufacturer.

Technical data

Socket	Safety socket outlet IP54
Nominal voltage / -current	250 V / 16 A
Degree of protection	IP54
Measurements (L x W x H)	168 x 106 x 102 mm